



# WAREHOUSE STORAGE EQUIPMENT

# WAREHOUSE STORAGE EQUIPMENT



## WIRE MESH DECKING • DIVIDERS • SIDEWALLS • COLUMN PROTECTIONS

Rejs offers to manufacture complementary elements for pallet racking. All parameters are **individually selected according to customer needs**, requirements and expectations.

### WIRE MESH DECKING & SHELVING

Mesh decking and shelving allow the adaptation of the storage pallet racking, unit and bulk items, optimise storage space, improve organisation, work efficiency, and increase safety - for stored goods and warehouse staff.

Mesh shelves increase the level of fire safety in the warehouse, the mesh allows water to pass through to the lower levels and does not effect load-bearing when wet. The mesh shelves do not obstruct light and visibility and allows easier manoeuvring of the load.

Mesh deck doesn't accumulate dust it's make it easier to keep the warehouse clean.

We are able to weld meshes of max. 1800x2700 mm, wire diameter 3 to 12 mm with any type of mesh.

We produce from raw or zinc wire.

We offer to galvanize and powder paint elements from raw wire.

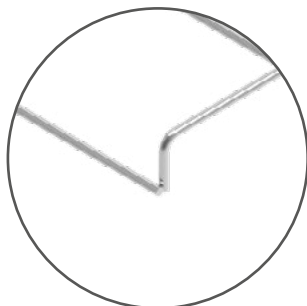

Our shelves are finished with „safe wire”, which protect against injuries and increases the safety of warehouse staff.

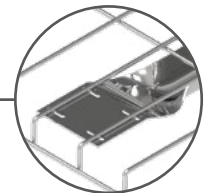
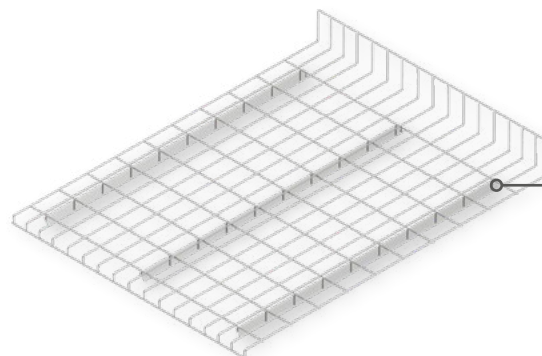
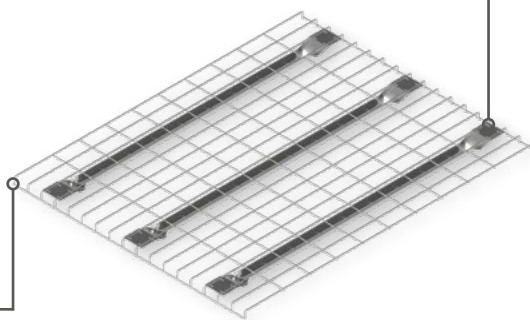

Reinforcement Omega profiles

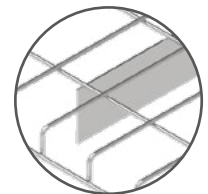

Flat bar reinforcement

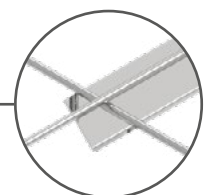

Reinforcement V profiles

## DIVIDERS, SHELF SEPARATORS

Storage space separators facilitate the organisation of storage shelves. We manufacture dividers from wire of various diameters and with the addition of tubes or profiles. On request, we manufacture separators of various construction to ensure maximum safety for operators.

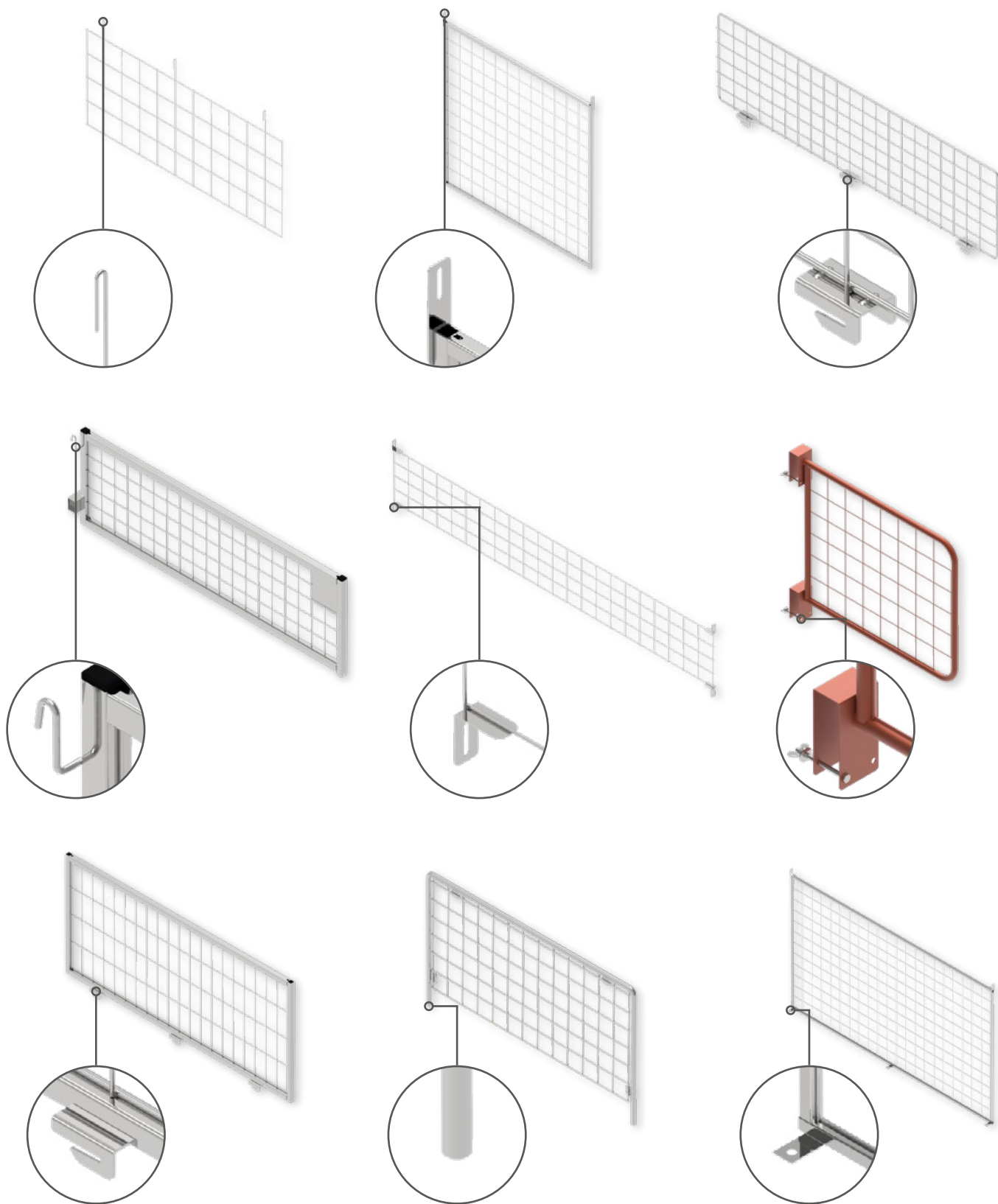

We offer many types of framing and attachment, any mesh size and wire thickness!

## SIDEWALLS AND BACK WALLS

Side and rear elements allow individual storage areas to be separated. It facilitates order maintenance by preventing the accidental movement of items between racking locations.

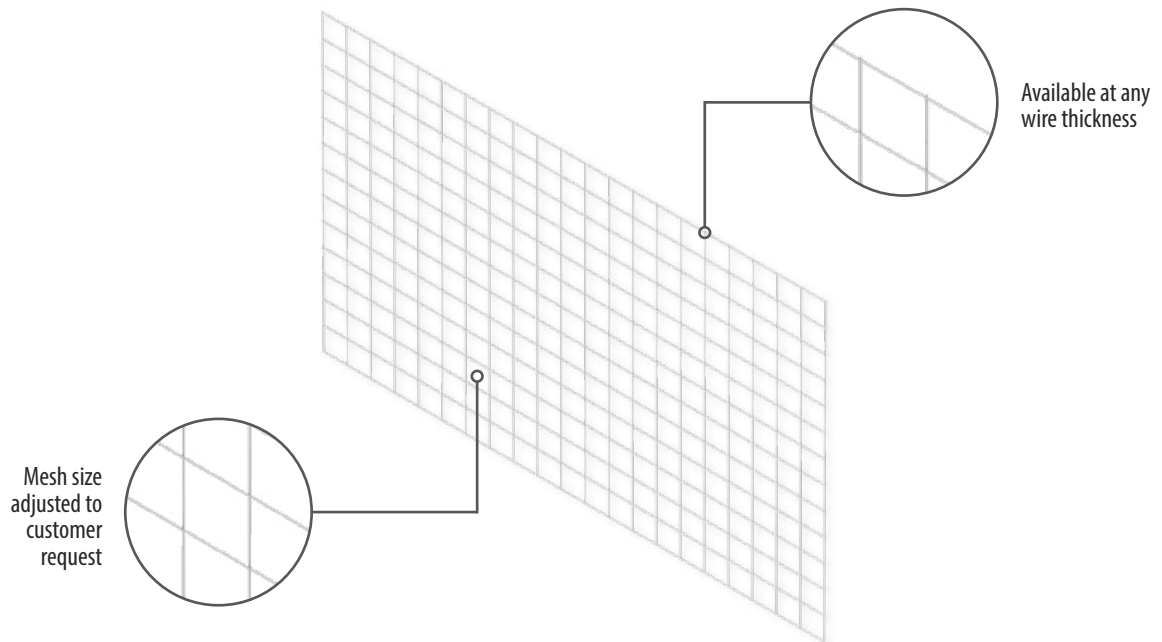

## STEEL WAREHOUSE COLUMN PROTECTORS

Column protection elements have an indirect effect on extending the service life of the main storage space constructions. The column protector prevents damage to the column, both in terms of mechanical deformation and tearing from corrosion protection coatings, which can lead to the structure rusting at a later stage.

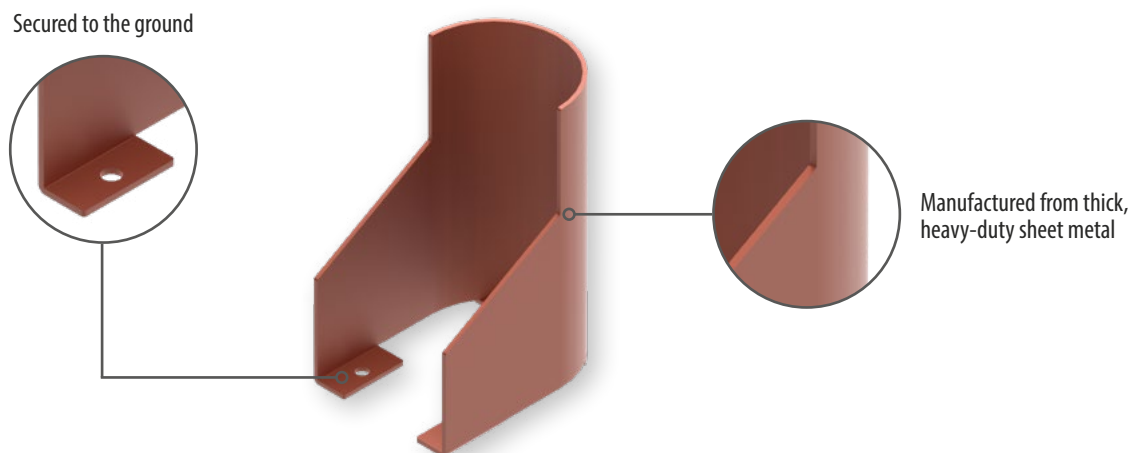

## EXAMPLE OF WAREHOUSE RACKING DESIGN

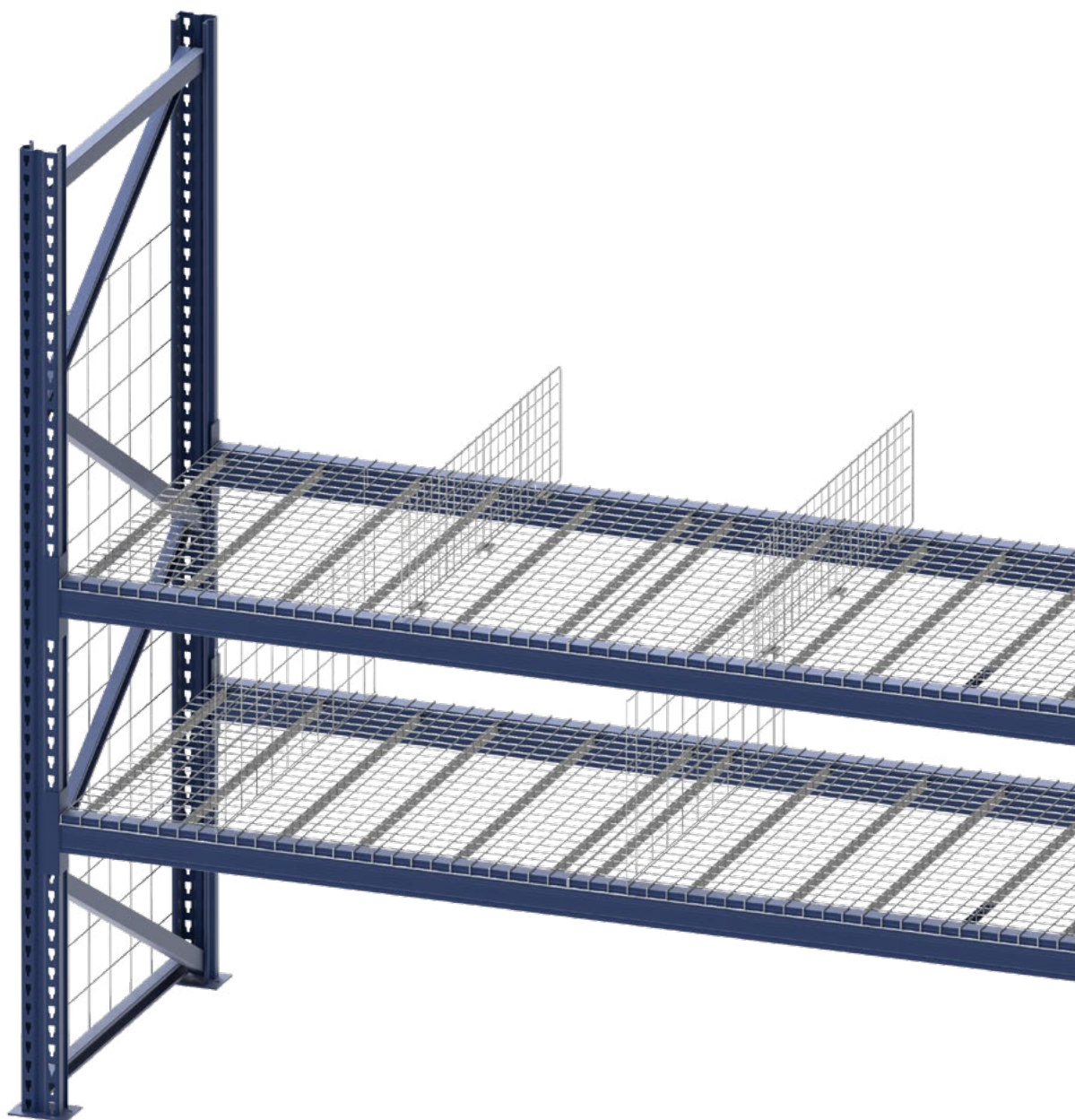

**CONTACT US:**

e-mail: [siatki@rejs.eu](mailto:siatki@rejs.eu)

Download catalogue  
digital version!



**HEADQUARTERS:**

REJS Spółka z o.o., 87-500 Rypin, ul. Mławska 61  
BOK + 54 280 5651, [www.rejs.eu](http://www.rejs.eu)



[e-rejs.eu](http://e-rejs.eu)



[RejsRypin](#)



[REJS Group](#)